

EPA 504

COLLAR TRIMMER MACHINE

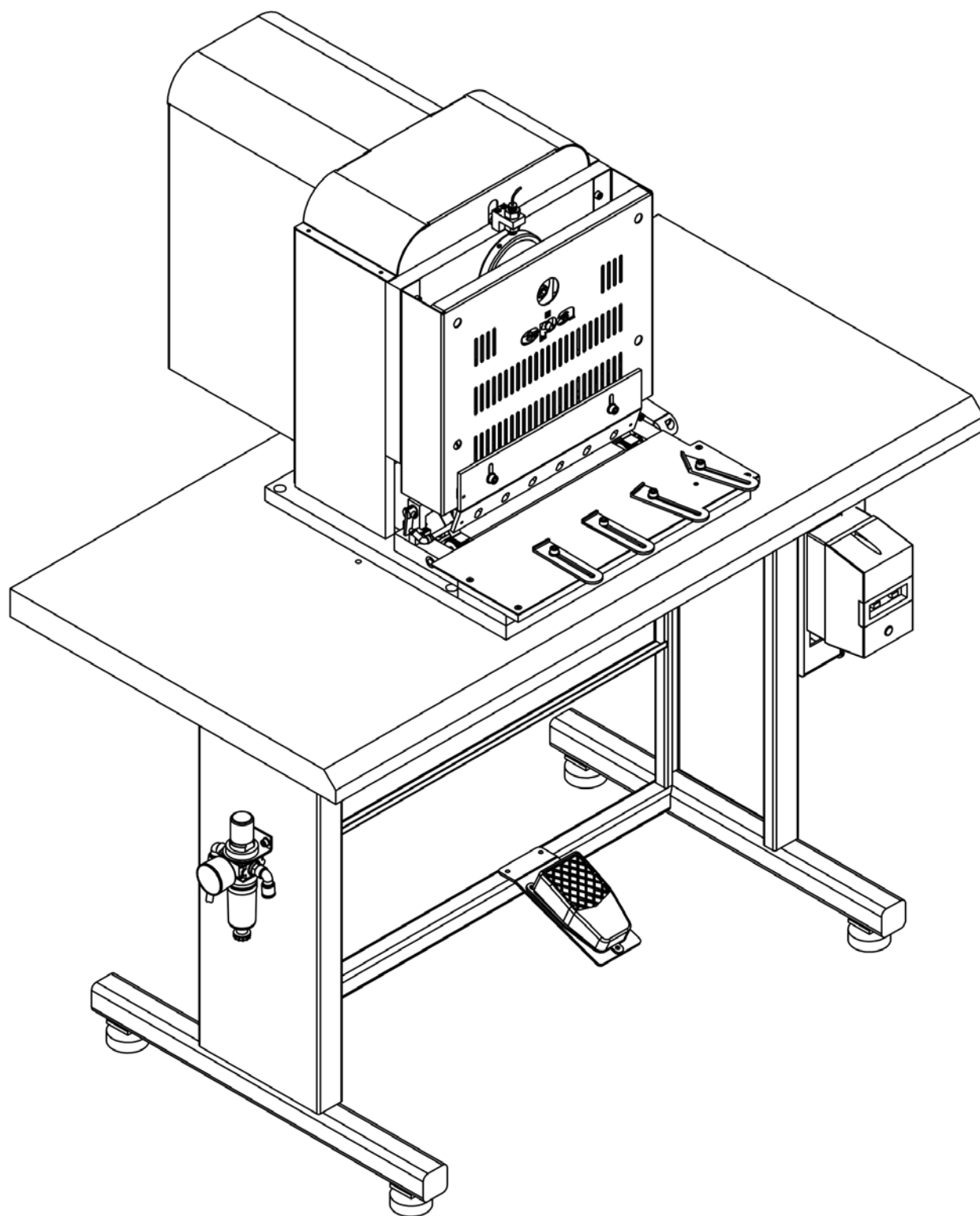

MODEL : EPA 504



QA-AC-1349/13

QA TECHNIC – UYGUNLUK ONAYI
QA TECHNIC – ATTESTATION OF CONFORMITY

MAKİNA EMNİYETİ YÖNETMELİĞİ (2006/42/AT)
MACHINERY DIRECTIVE (2006/42/EC)

EPA TEKNOLOJİ VE OTOMASYON MAKİNALARI SAN. TİC. LTD. ŞTİ.
BAĞLAR M. OSMANPAŞA CD. NO:59/5 BAĞCILAR
İSTANBUL/TÜRKİYE

Ürünün Tanımı
Description of the Product/Product Part

: GÖMLEK ÖN PART MAKİNASI
SHIRT FRONT PART MACHINE

Markası
Trade Marks

: EPA AKIN

Model/Tip
Model/Type

: EPA SERİSİ

Uygulanabilir AT Direktifi
Applicable EC Directives

: 2006/42/AT
2006/42/EC

Uygulanabilir Harmonize Standardlar
Uygulanabilir Ulusal Standardlar
Ve Teknik Spesifikasyonlar
Applicable Harmonized Standards/

: TS EN 60204-1

Rapor No & Rapor Tarihi
Report No & Report Date

: M-LVD-713/13, 04.11.2013

İşbu belge incelemesi yapılan ürün tasarımı için geçerlidir. Ürünün değiştirilmesi halinde bu belge geçerliliğini kaybedecektir.
The Present certificate is valid just for the analysed product design. The certificate shall lose its validity in case of any changes in the product.

Sertifika Yayın Tarihi : 12.11.2021
Certificate Issue Date
Geçerlilik Tarihi : 12.11.2024.
Validity Date



ALBERK QA ULUSLARARASI TEKNİK
KONTROL VE BELGELENDİRME A.Ş.
BARBAROS MAH. AK ZAMBAK SOK.
A BLOK KAT.19 No:2 ATASEHIR
İSTANBUL / TÜRKİYE
Tel : 0216 572 49 10-11-12
Fax : 0216 572 49 14
www.qatechnic.com



L. Murat YILMAZ
Genel Müdür / General Manager

EC Declaration of Conformity

We **EPA TEKNOLOJİ VE OTOMASYON MAKİNALARI SAN. TİC.LTD. ŞTİ.**

Of İkitelli OSB, Mutsan Sanayi Sitesi 4.Blok No: 17-19-21 BAŞAKŞEHİR/İSTANBUL/TURKEY

in accordance with the following Directive(s):

2006/42/AT
2006/42/EC
2006/95/EC
2004/108/EC



Hereby declare that:

Equipment: **SHIRT TRIMMING AND MARKING MACHINES**

Model number: **EPA 400-04 COLLAR TURNING AND TRIMMING HORIZONTAL
EPA 400-05 COLLAR TRIMMING AND TURNING VERTICAL
EPA 400-06 COLLAR TRIMMING AND TURNING TWO HEAD
EPA 504 COLLAR TRIMMER
EPA 208 SHIRT FRONT-PLACKET TRIMMING
EPA 150 SPOT STICKING MACHINE FOR LINING
EPA 503 THREE POINTS MARKING MACHINE**

is in conformity with the applicable requirements of the following documents

Ref. No. Title Edition/date : **QA-AC R-1358/13, 04.11.2013**
EC Directive of Elektromagnetic Compatibility (89/336/EEC)
EC Low Voltage Directive (73/23/EEC)

Applicable harmonized Standards : **TS EN 60204-1, TS EN 12100:2010**
TS EN 60204-31 :19987AC2000
TS EN 60204-01

We hereby declare that the equipment named above has been designed to comply with the relevant sections of the above referenced specifications. The unit complies with all applicable Essential Requirements of the Directives.

Signed by:

Name:

**EPA TEKNOLOJİ VE OTOMASYON
MAKİNALARI SAN. TİC. LTD. ŞTİ.**
İ.O.S.B. Mutsan San. Sit. 4. Blok
No: 17-19-21 Başakşehir / İST.
İkitelli V.D. 336 056 1719

CONTENTS

LABEL INFORMATIONS	5
01-MACHINE CONTROLS	6
02-GENERAL FEATURES	7
A-CHARACTERISTICS AND APPLICATION AREAS	7
03-SECURITY MEASURES	8
A-TRAINING	8
B-CONDITIONS THAT YOU NEED TO TURN OFF POWER OF EPA MACHINE.....	8
C-CONDITIONS THAT YOU NEED TO TAKE SECURITY MEASURES	9
04-EPA 504 TECHNICAL INFORMATIONS	10
05-LIFTING AND TRANSPORT	11
06-LOADING AND UNLOADING	11
07-INSTALLATION AND SET UP	12
08-ELECTRICAL CONNECTIONS	13
09-PNEUMATIC CONNECTIONS	13
10-ADJUSTING THE MACHINE	14
A-CHANGING BLADE	15
11-MAINTENANCE	16
12-SPARE PART CHARTS	17

LABEL INFORMATIONS

Machine name	Collar Trimmer machine
Type	EPA 504
Serial Number	
Production Date	
Voltage	380 V
Power	700 Kw
Weight	135 Kg
Operating Pressure	4-6 Bar

01-MACHINE CONTROLS

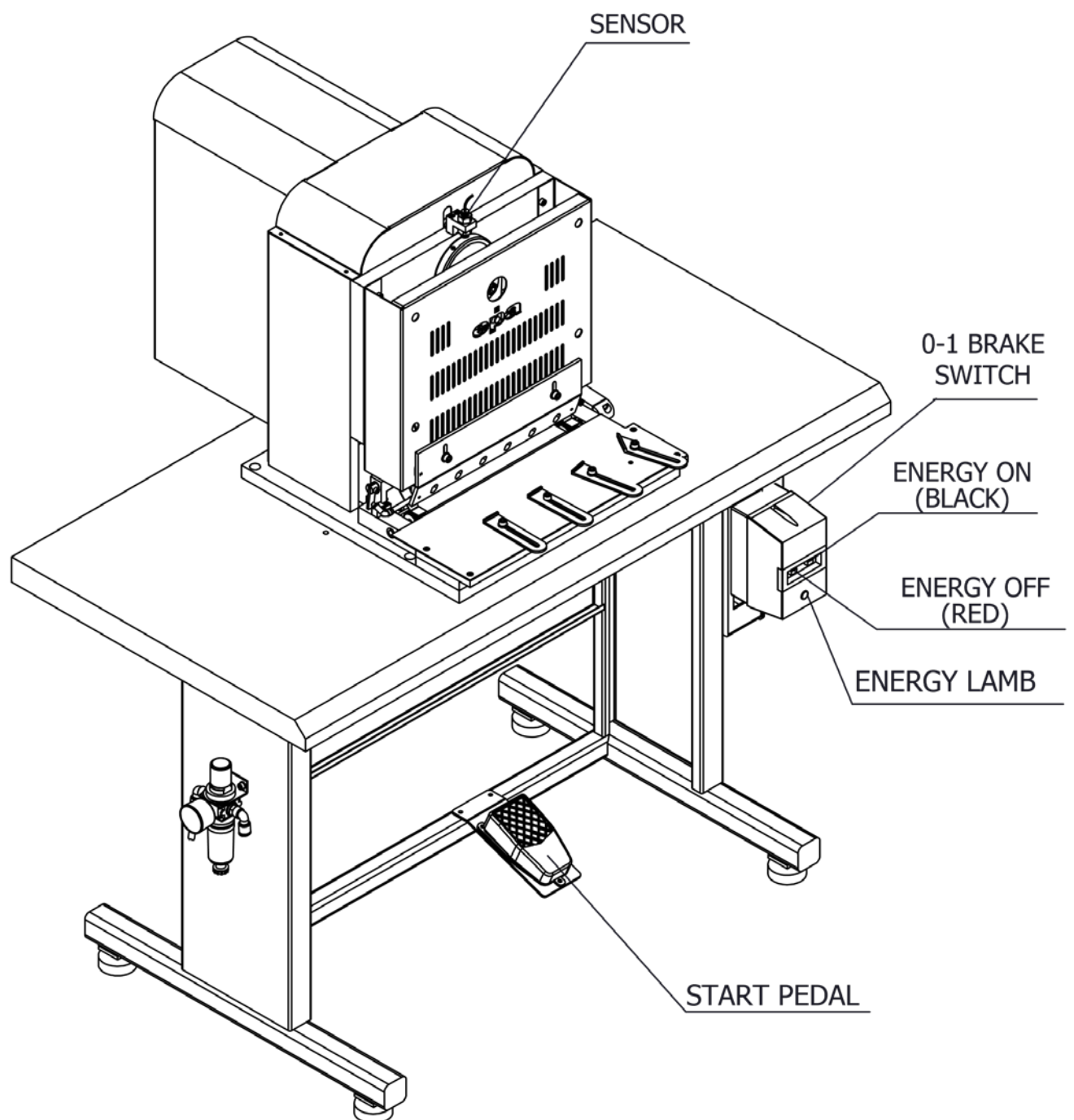

02-GENERAL CHARACTERISTICS

A-CHARACTERISTICS AND APPLICATION AREAS

EPA 504 collar trimmer machine is only used at cutting cloths like shirt, blouse. In case of a false use other than stated at this handbook, happened to people or goods from accident and damages, producing company can not be held responsible.

It provides fast and standard collar under cutting.

It has adjustable knife for any kind of collar curves. It accelerates the process before adding the collar to the cummerbund. It has a developed security mechanism.

It has optional air cleaning system.

During usage of the machine, security flexies at its front side definitely exists on the machine.

The operation of blade changing ergonomical characteristics so workers do not need to spend too much effort.

Pay attention when you touch these parts. (Figure.1)

A- Security flexi up

B- Security flexi down

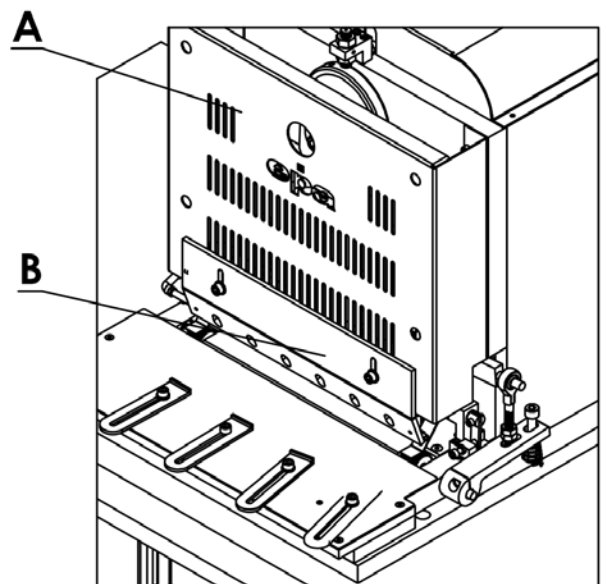

Figure.1

ATTENTION:

Before starting machine maintenance, part changing or adjustment please disconnect the machine from basic power supply source. And wait cooling parts of the machine. Do not make any operation unless you are sure of the electricity connection.

Do not use your machine under heavy dust environmental conditions.

The machinery is never exposed to open air conditions like rain, snow etc.

03-SECURITY MEASURE



At place it has seen next figure, that means to endanger for health of user. Therefore while it is walked up, it is necessary more to be careful.

Firstly stop the power, if you need open control panel which contains electrical parts.

Before using the machine, please read manual instructions and other explanatory which is the part of machine accesories. Keep manual and explanatory documents as easy reference guide well.

To avoid death or injury, do not use your machine without instructions on your manual.

EPA company does not admit any responbility about accident or injuries comes out due to the machine have been used out of purpose of usage.

To avoid accidents cause to death and injuries, do not modify the machine.

EPA company does not accept any responsibilities about accident comes out due to the machine modifications.

A-TRAINING

Operators should be sufficented regarding machine use. In order that conditions they need a training plan and train them prior.

B-CONDITIONS THAT YOU NEED TO TURN OFF POWER OF EPA MACHINE

If there is a anormal case, breakdown or power failure in order to protect against accidents caused to death or injuries, absolutely turn off the power.

Turn off power during it is turned into or adjusted parts of machine.

During control, maintanance or while leaving next the machine, absolutely turn off the power.

Because of preventing electrical shock, earth fault or fire, do not hold the cable unplug from power point.

C-CONDITIONS THAT YOU NEED TO TAKE SECURITY MEASURES

After lifting the machine while you were replacing, it is necessary to consider weight of machine. For weight of machine, look over chapter "LABEL INFORMATIONS".

Before lifting or replacing the machine, in order to avoid injuries or led to death accidents, take essential security measures against drop or roll.

To avoid accidents cause to death or injuries, before opening the power, control that connector and cable non-damaged, whether loose or out cable.

Definitely do not put your hand to the machine which is in operation.

Do not touch to the parts in machine which have very high temperature.

While changing any parts of the machine, absolutely use original EPA parts. EPA is not responsible occurs from accidents in case of using unoriginal parts under no circumstance.

To avoid accidents originating from electrical shock or lack of information about machine, consult technicians of your company are trained by EPA.

Before starting works as maintenance, part changing, adjustment quit the machine from main power source, compressed air sources and wait cooling of ironing parts.

Surely control whether there is a loose screw or loaf after maintenance, adjustment or changing.

Absolutely clean the machine regularly.

After maintenance if the machine still do not work properly, to avoid accidents cause to death or injury consult to EPA technical service urgently.

04-EPA 504 TECHNICAL INFORMATION

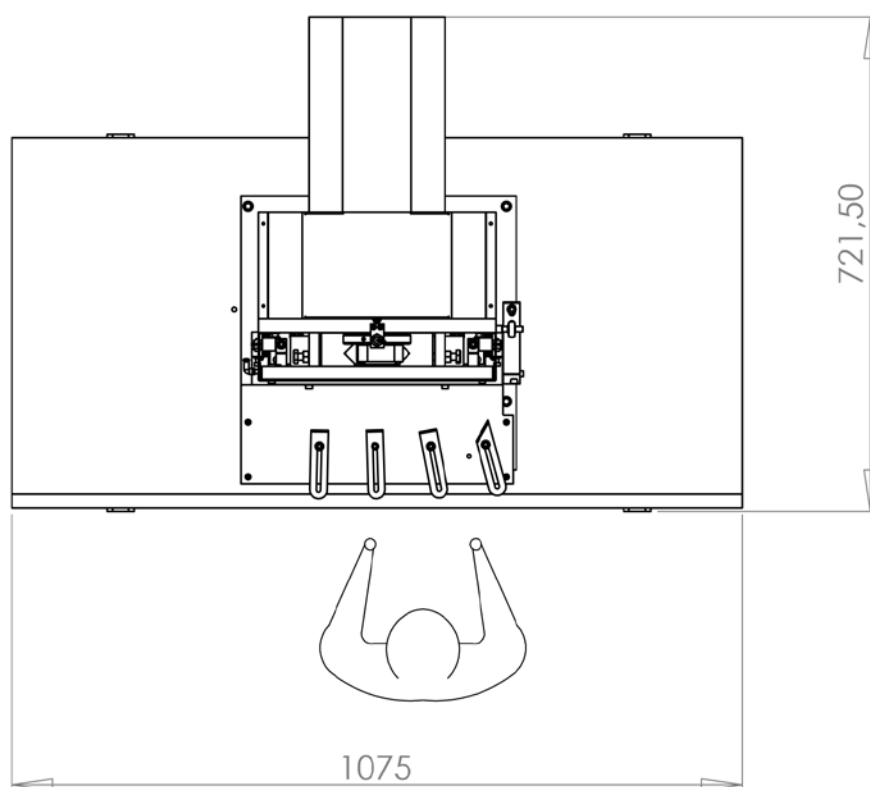
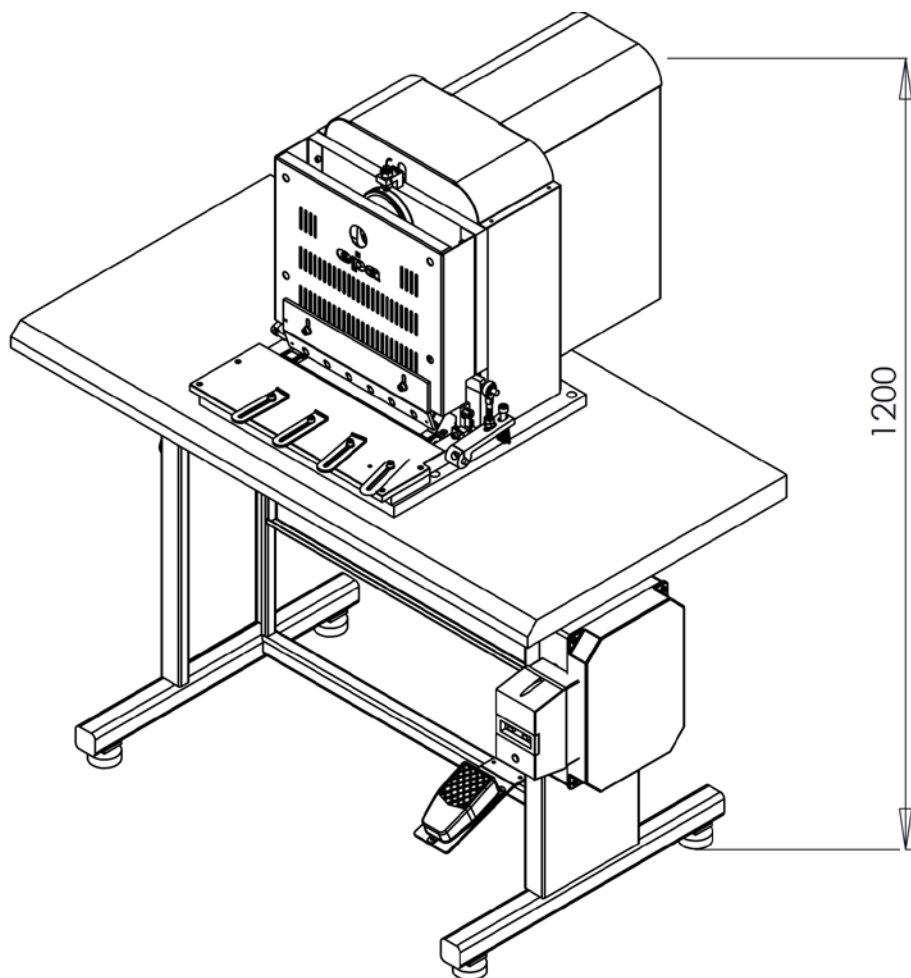

05-LIFTING AND TRANSPORT

EPA 504 is conveyable with packaged or not. In either case, ensure forks of fork- lift truck adjusted as to exact weight of the machine. While machine is moved with fork-lift truck, front face of machine turned to fork-lift truck pass forks under the machine. Place van or pick-up truck and bond belt or ropes.

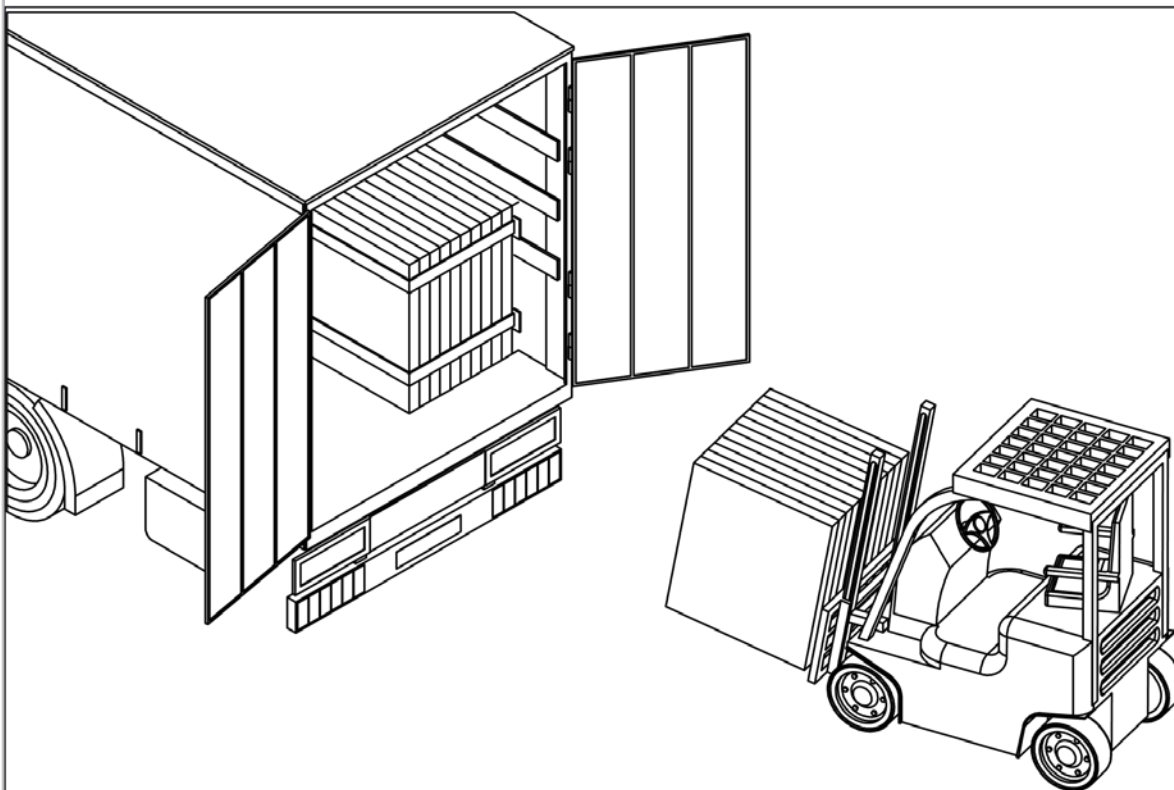

06-LOADING AND UNLOADING

Ensure forks of fork- lift truck adjusted as to exact weight of the machine. Take out the package and lift front face of machine turned to fork-lift truck is passing forks under the machine. After placing it on a hard and plain surface not subject to any weather condition and then move it.

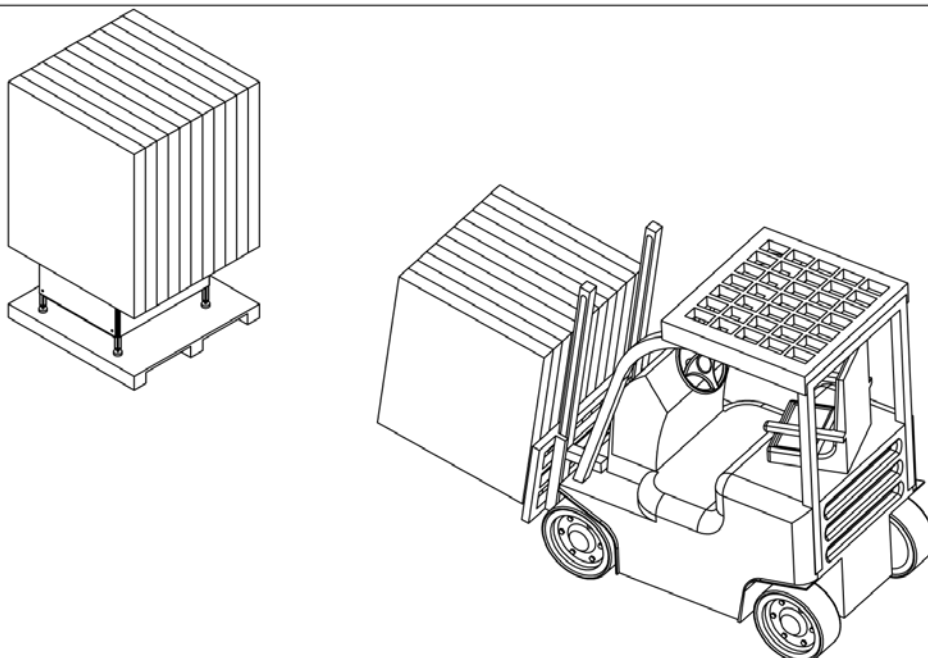

07-INSTALLATION AND SET UP

ATTENTION: This machine have to set up by experts.

Producer company can not be held responsible to problem and faults that it is resulted from inadequate links in case of not working the machine in respect of wrong set up and main power sources not parallel to informatics provided here.



If the machine will be set up over a stationary surface, please control whether surface can be removed weight of the machine. If there is burnable/ explosive/ sparkler around the machine, definitely do not set up here.

Control the machine for working and maintenance needed blank during machine setup so as to provided. Machine has to be replaced over stiff and plain surface.

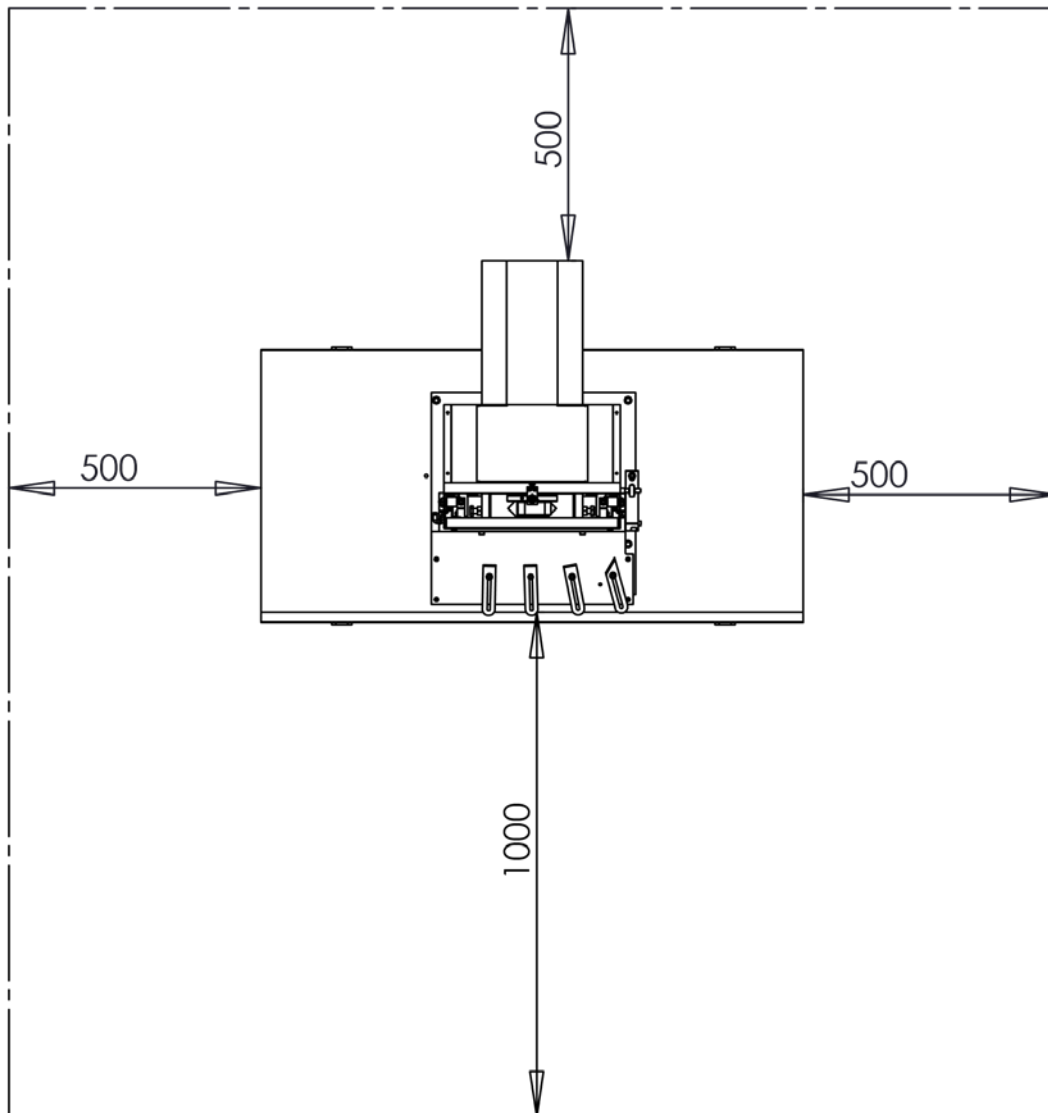

Figure.2

08-ELECTRICAL CONNECTIONS

Open side panel (Figure.3-A) to connect the power cable.

- 1- Pass the cable from the mortises on the machine.
- 2- Connect R-S-T phases and neutral to related terminals.
- 3- Provide 380V power to the machine.

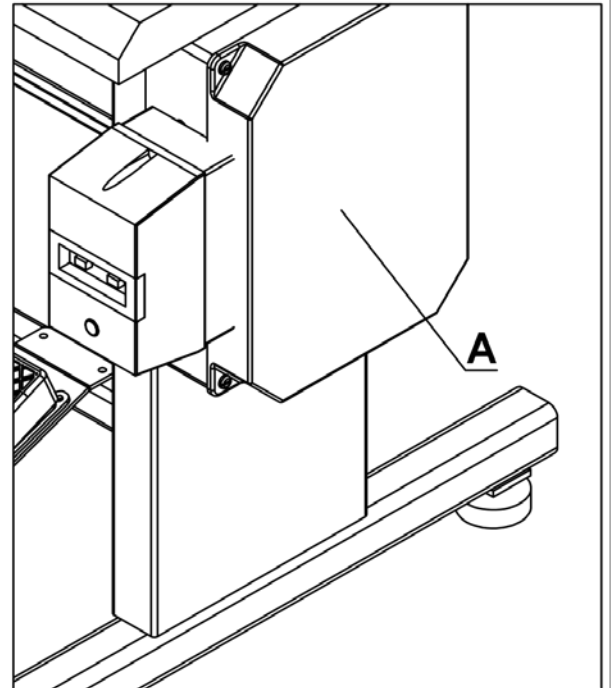

Figure.3

09-PNEUMATIC CONNECTIONS

Connect the machine to compressed air output. (Figure.4-A)

Bring pressure at the manometre (Figure.4-C) between 4-6 Atm by doing over the pressure controller. (Figure.4-B)

Discharge water in the filter unit from below stopper (Figure.4-D) by controlling permanently.

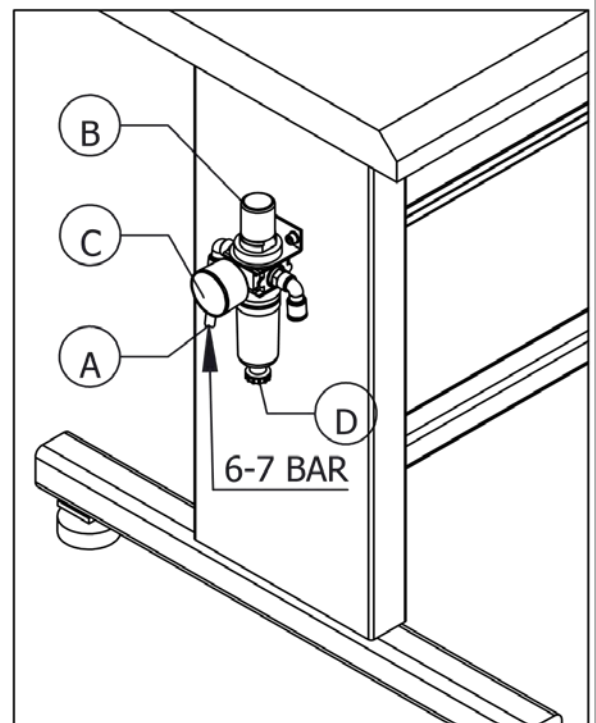

Figure.4

09-ADJUSTING OF THE MACHINE

It is done all of settings of the EPA 504 machine in our factory during shipment of the machine. According to the fabric you will make only the cut, it will be done adjustments if the blade. (Figure.5)

- Firstly turn the motor break button to -0- position.
- Down the head in the way that knife will be touching to the table.
- Do not take out the front security sheet metal while you are adjusting the machine definitely.
- Lean both edge sides of part will be cut of the jig to knife.
- Tighten fitting screws by leaning stoppage foot to the jig.
- Give shape to the blade with the help of alignment screws according to jig of the collar will be cut.
- It is obtained cutting jig of largest size of the collar that will be cut. And its side that will be cut should be replaced to flange toward the knife.
- Bring the motor brake button to -1- position and start to cutting process by pressing the pedal.

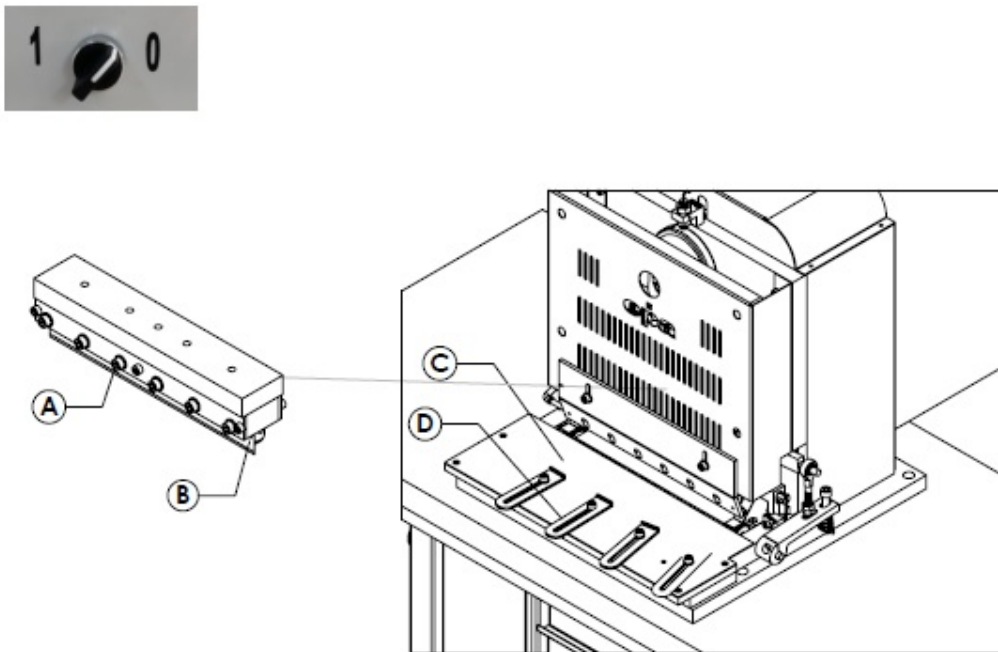

Figure.5

- A- Alignment screws (6 number)
- B- Cutting blade
- C- Frangle
- D- Collar adjusting stoppage (4 number)

10-CHANGING BLADE

Apply following operations for changing blade of the EPA 504:

- Firstly ensure to close energy of the machine.
- Take out fitting screws of old blade.
- Clasp new blade by hitting its proper holes exactly without tighten screws.
- After you mounted security sheet metal, bring the motor brake -0- position.
- Open the machine energy.
- Down the machine head manually until blade will touch to base.
- Close the machine energy again.
- Tighten screws of blade that touched to base.
- Pay attention that there is a no gap between blade and head.
- Tighten fitting screws when the blade is in the way.
- Mount the security sheet metal of the machine.
- Bring the motor brake button to -1- position and start to cutting process by pressing the pedal.

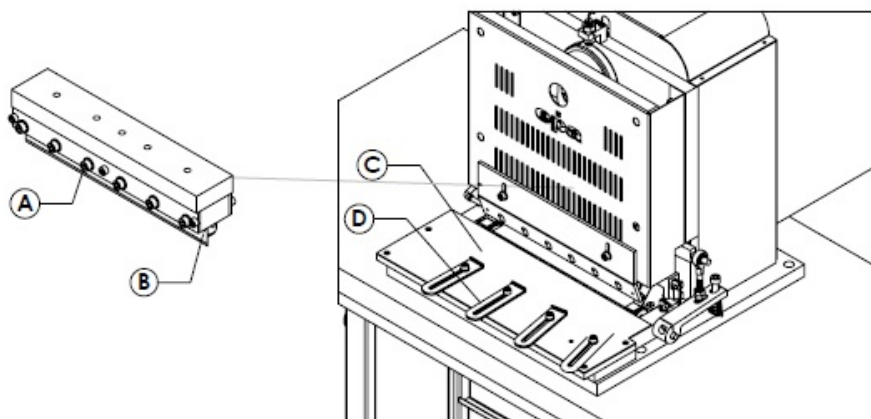

- A- Blade fitting screws (6 pieces)
- B- Cutting blade.

11-MAINTENANCE

Before starting works as maintenance, part changing, adjustment disconnect the machine main power source. This processes should be done by trained people.

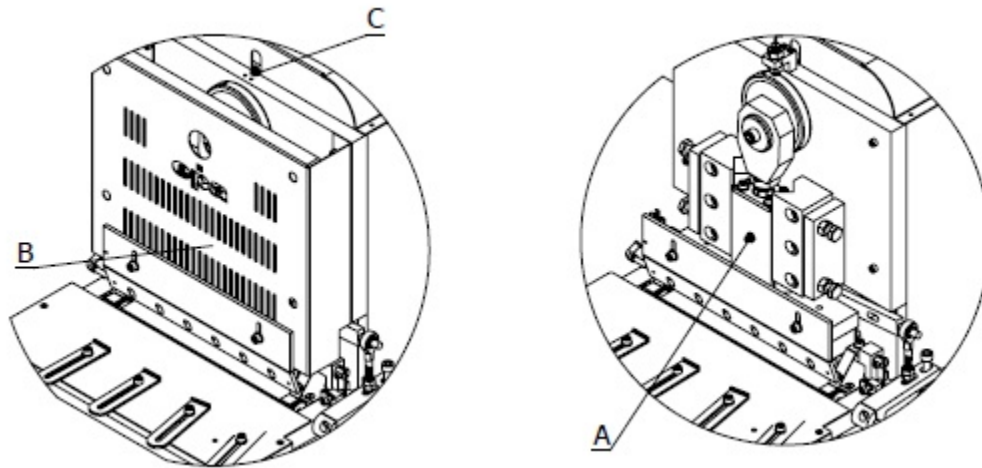

12-SPARE PART CHARTS

Please inform us about following infos, we can provide your spare part promptly:

Machine model and serial no

Spare part code

Check your code on your spare part chart.

Example : Collar trimmer machine Model **EPA 504** Serial no Code 'part

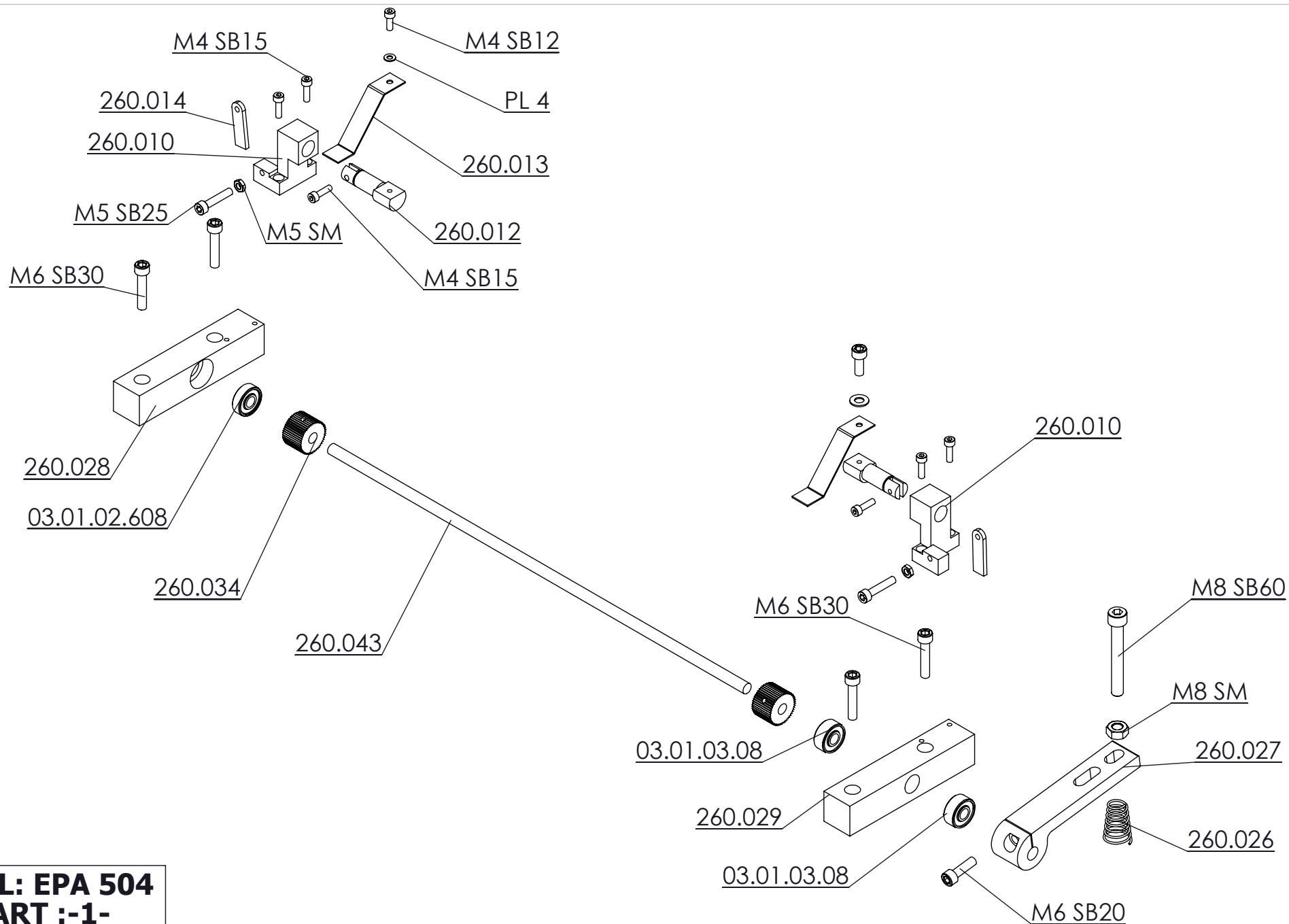

MODEL: EPA 504
CHART :-1-

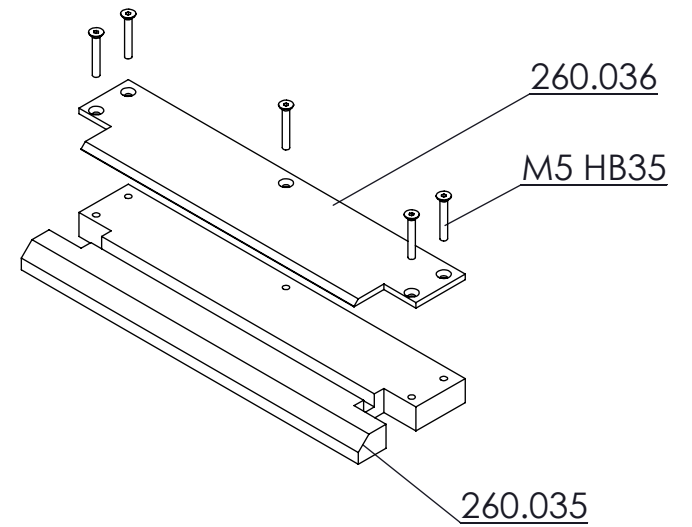
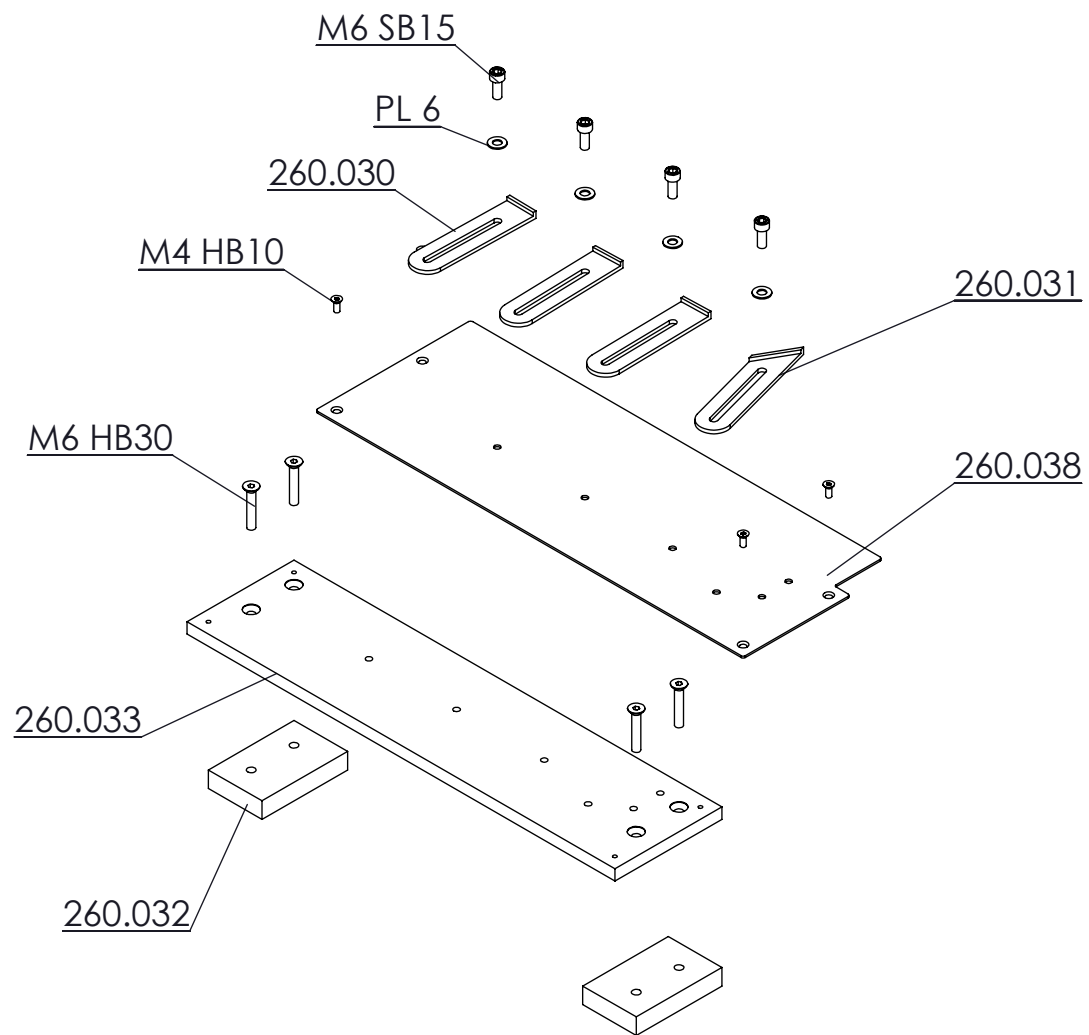

MODEL: EPA 504
CHART:-2-

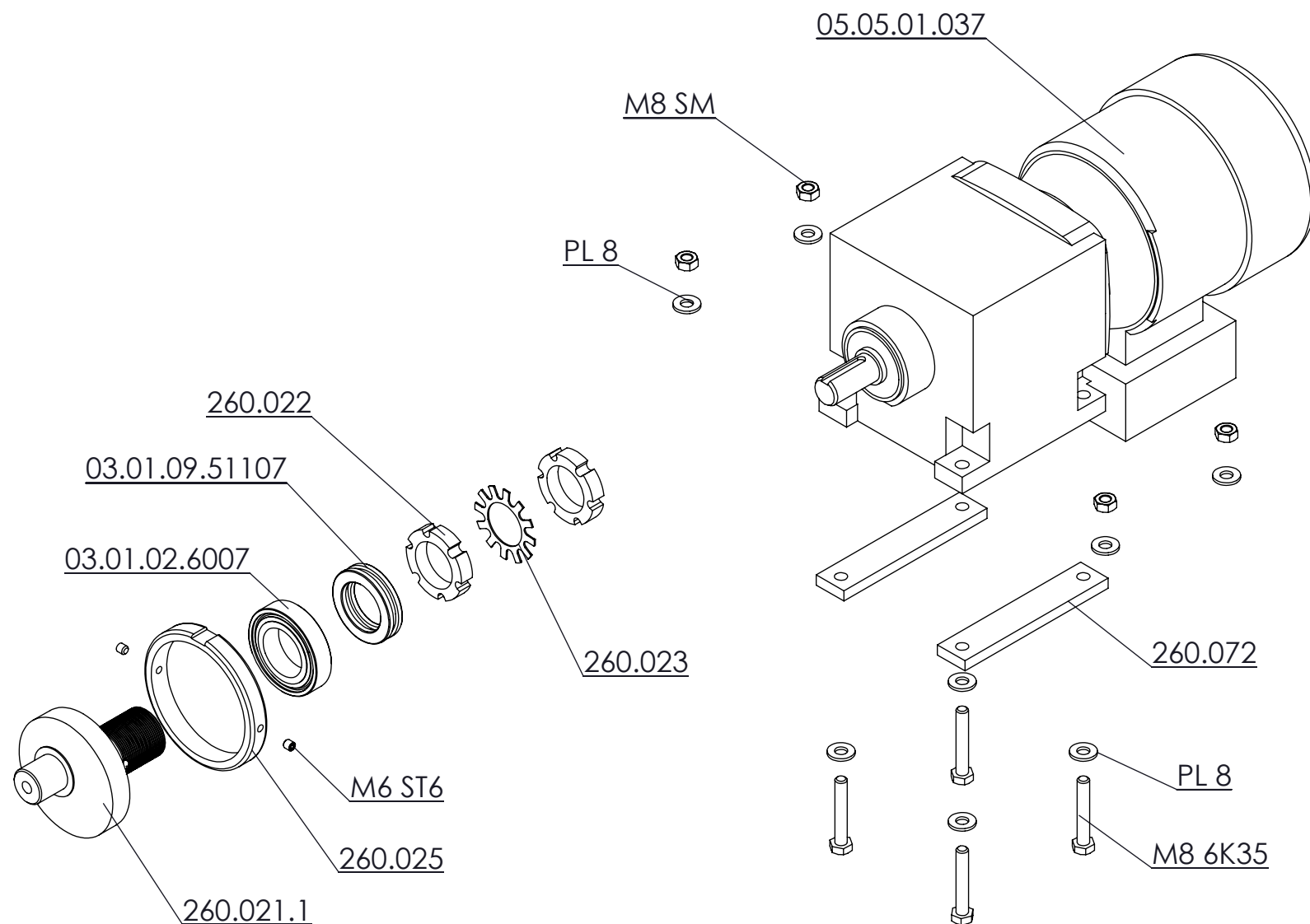

MODEL: EPA 504
CHART:-3-

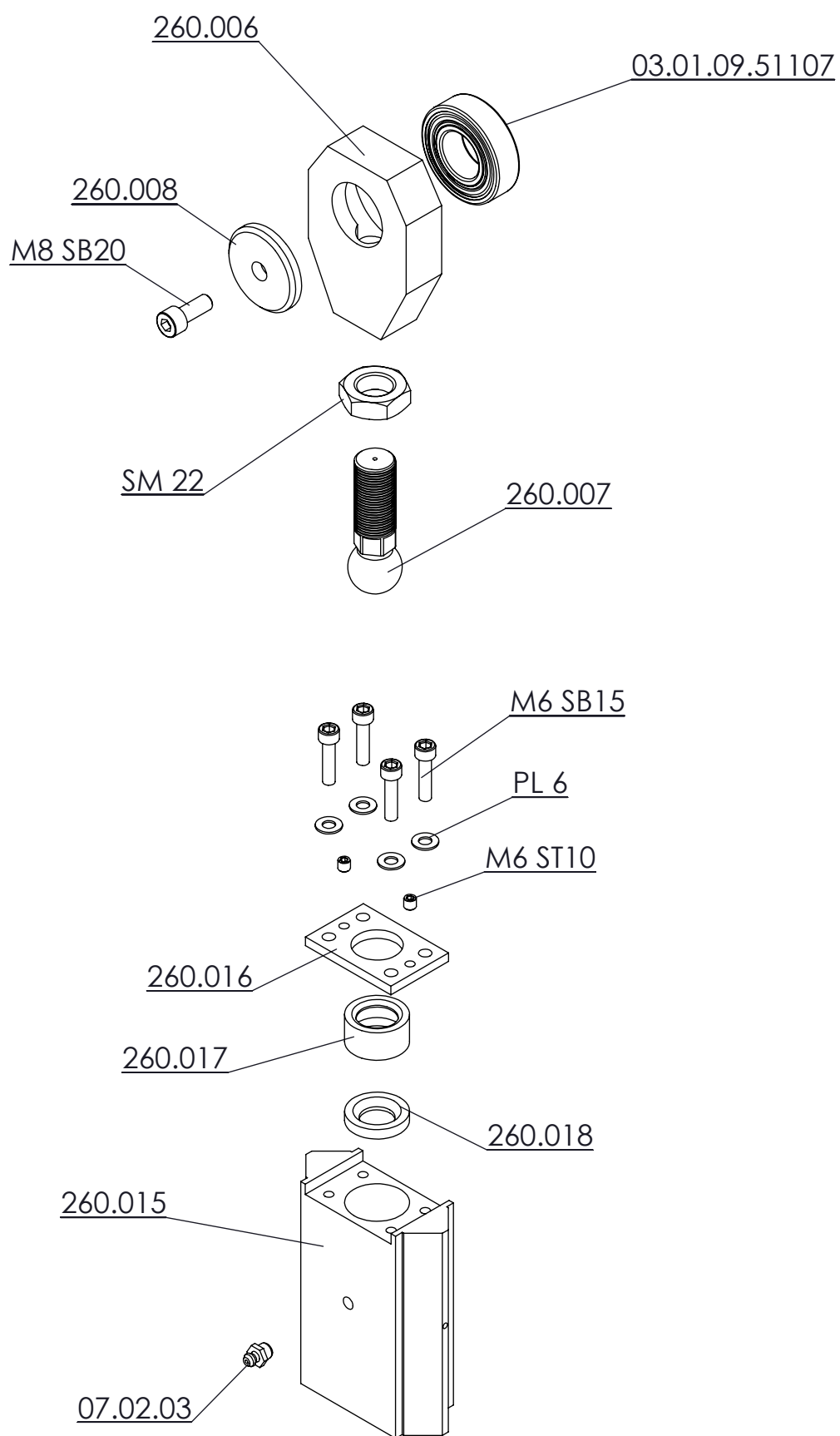

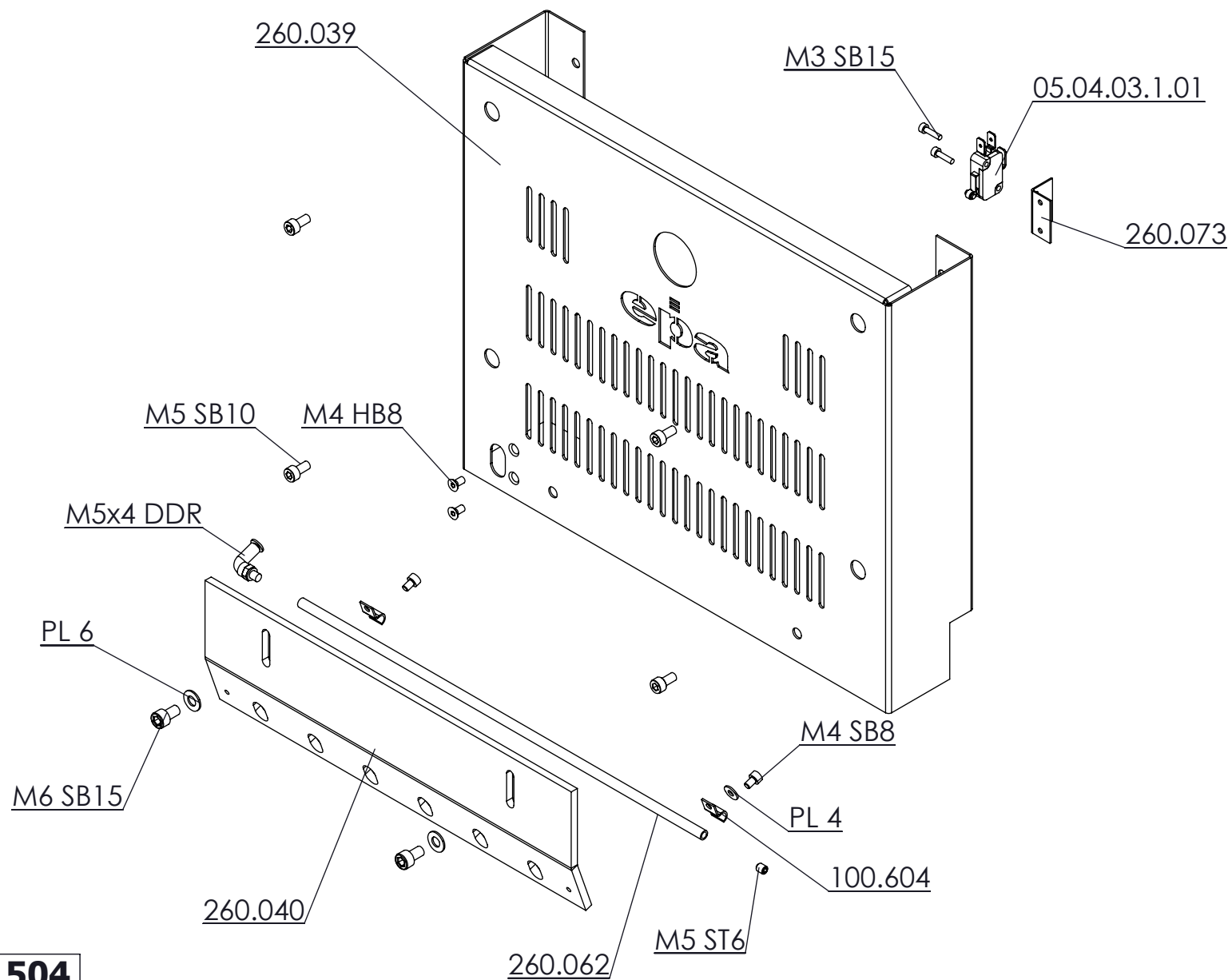

MODEL: EPA 504
CHART :-5-

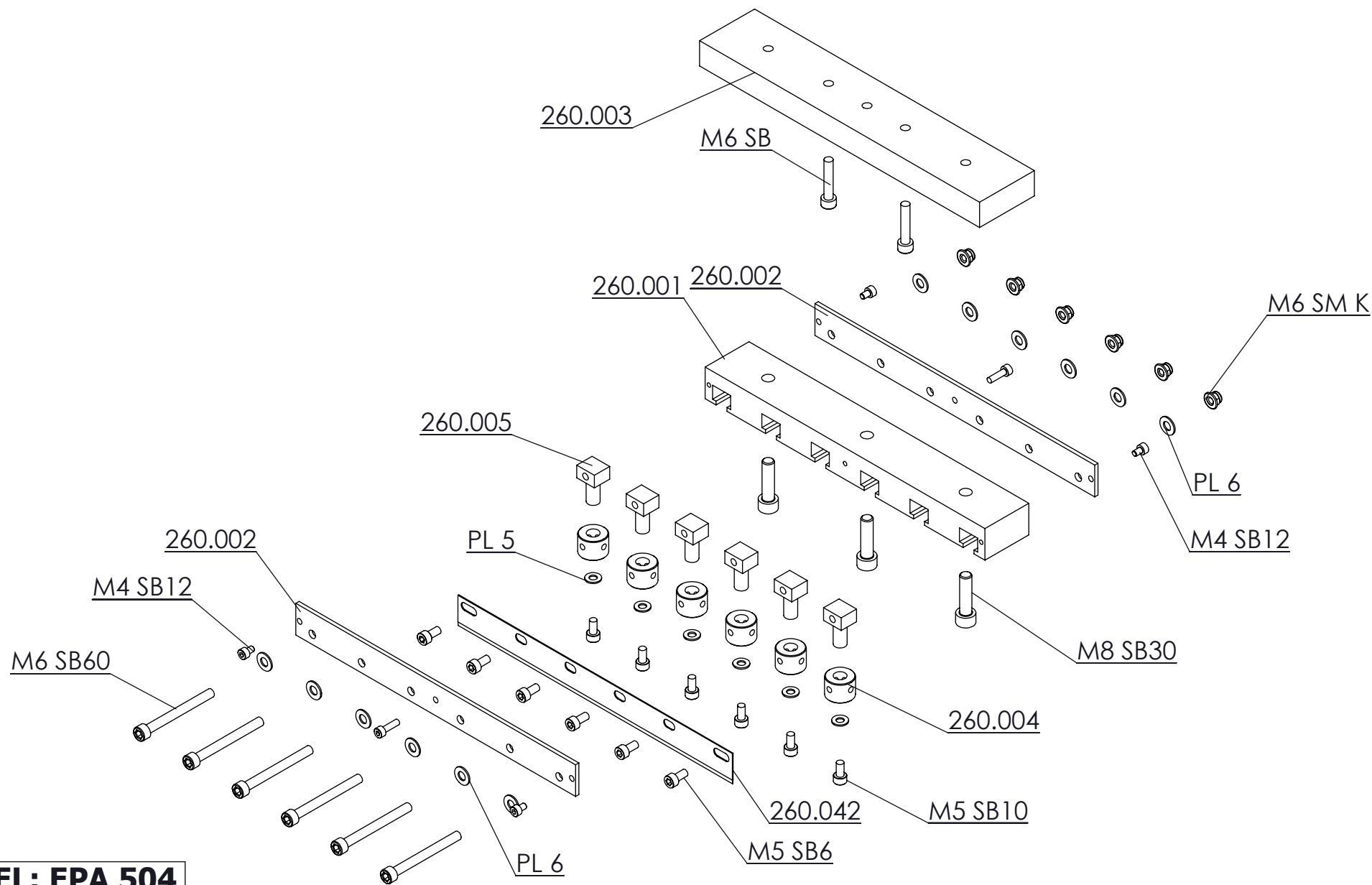

MODEL: EPA 504
CHART :-6-

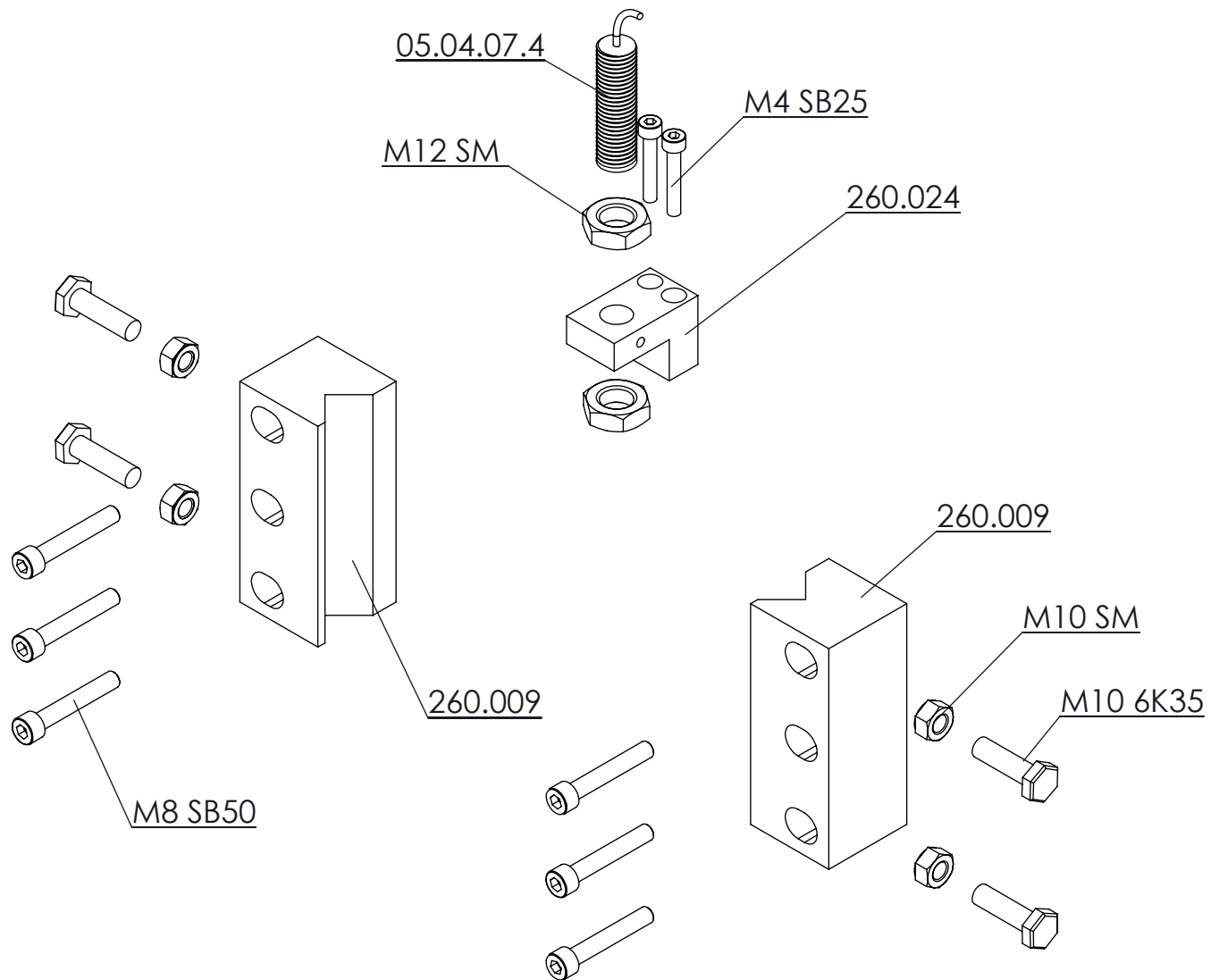

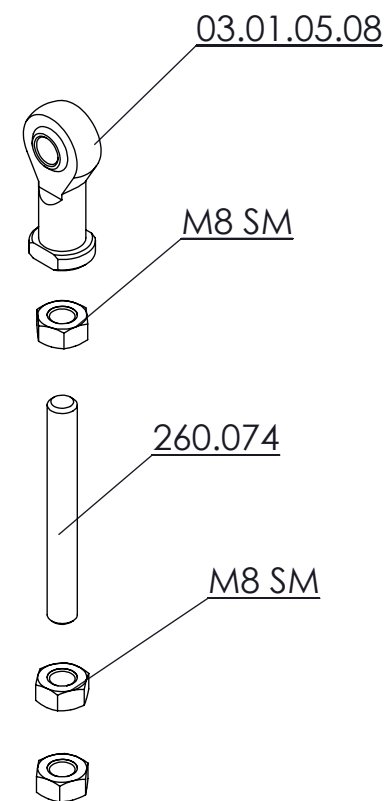
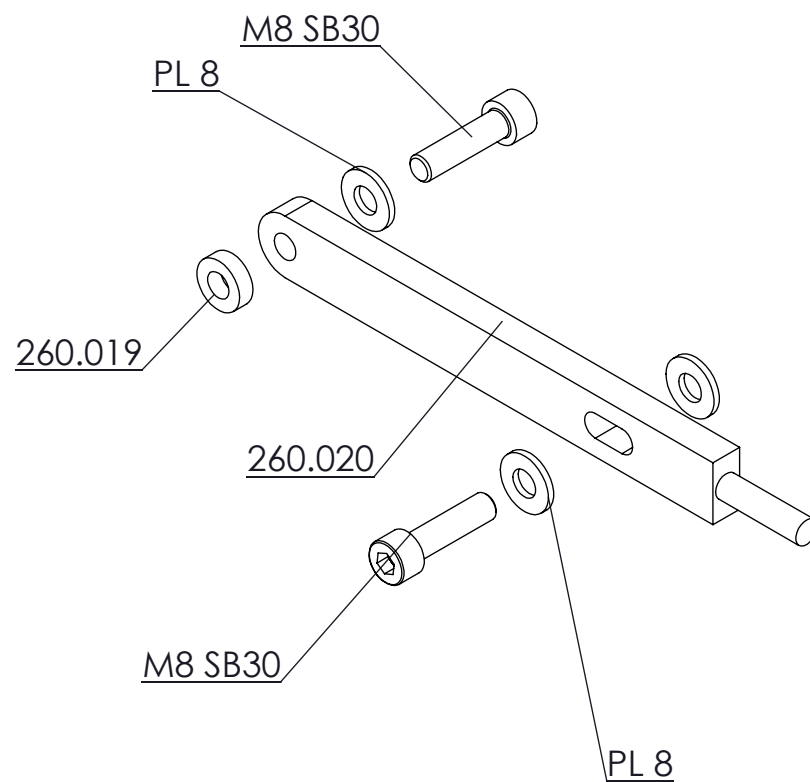

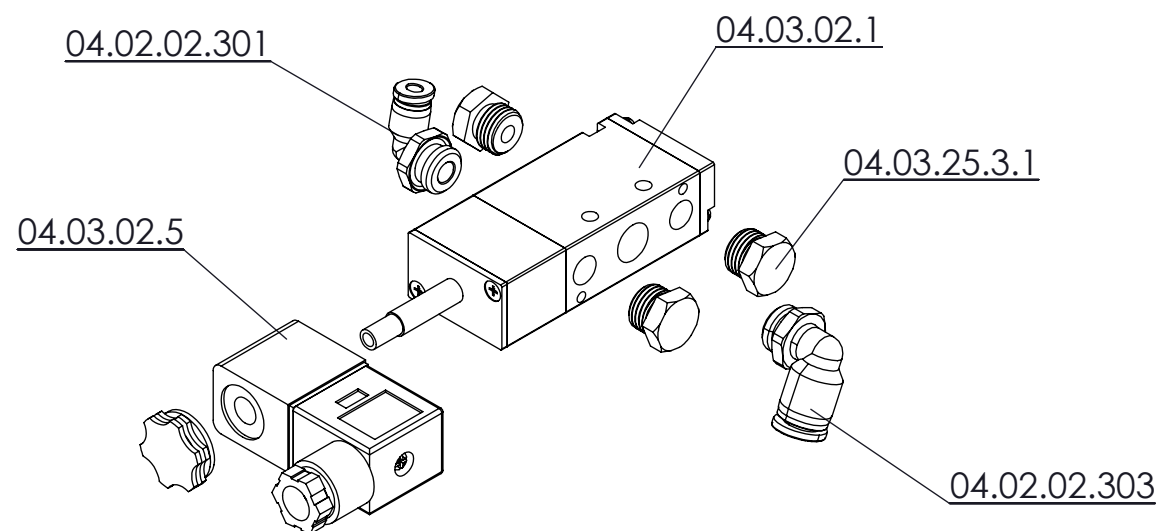

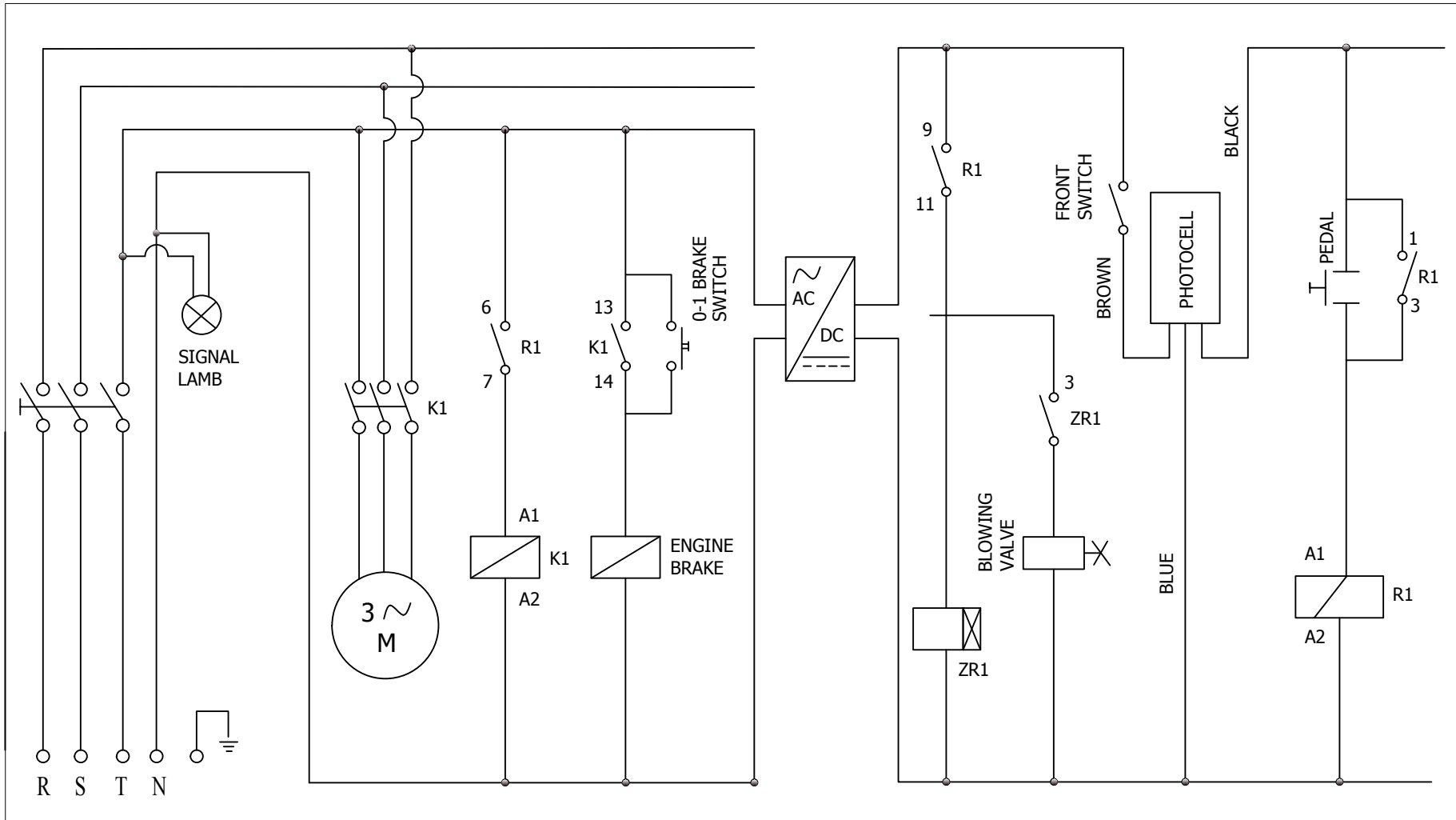

DRAWER	MELTEM TETİK			E-P-A AKIN
CONTROL	ERHAN ÖZSOY			
APPROVAL	ÖZCAN ÖZSOY	MACHINE MODEL	EPA 504	